

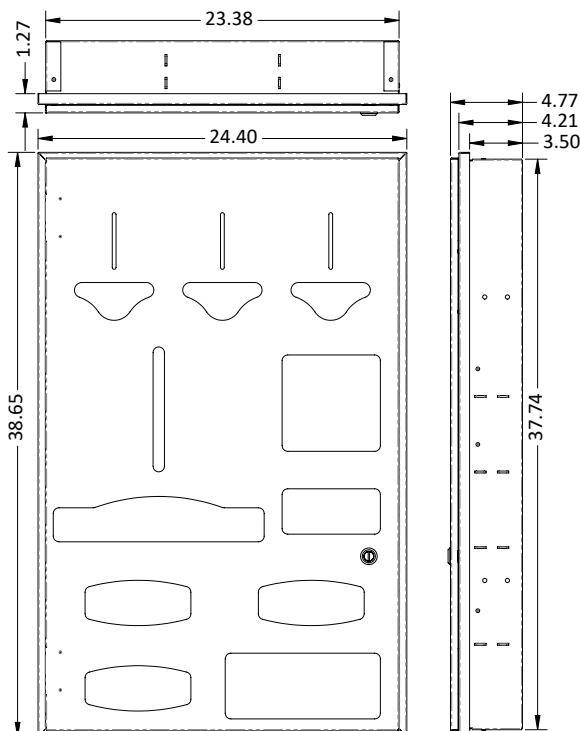

MADE IN THE USA  
PATENT PENDING

### Mounting Specifications:

- Installation should be performed only by a licensed contractor.



### Product Description:

- Semi-Recessed PPE Dispensing System
- Holds disposable or reuseable gowns, aprons, or coveralls/jumpsuits, one box of face shields, one box of earloops, three boxes of gloves, three bulk compartments and an area for miscellaneous items
- Low profile
- Slotted keyless cam lock
- Screw holes in sides to mount to stud framing in wall
- Quartz Beige Powder-Coated Steel

### Primary Area for Product Usage:

- Hazardous drug dispensing areas
- Sterile procedure dressing areas

### Dispenses:

- Top: Miscellaneous bulk items in each compartment, no larger than 7.78"W x 11.00"H x 4.03"D (19.8 cm x 27.9 cm x 10.3 cm)
- Middle left: Gowns, aprons, coveralls/jumpsuits folded no larger than 14.95"W x 14.45"H x 4.03"D (38.1 cm x 36.7 cm x 10.2 cm)
- Middle right: Box(es) no larger than 8.31"W x 9.48"H x 4.68"D (21.2 cm x 24.1 cm x 11.9 cm)
- Middle right: Box(es) no larger than 8.31"W x 4.93"H x 4.68"D (21.2 cm x 12.5 cm x 11.9 cm)
- Bottom: Box(es) no larger than 11.65"W x 5.61"H x 4.68"D (29.7 cm x 14.2 cm x 11.9 cm)

### Product Specifications (overall external dimensions):

- 24.40"W x 38.65"H x 4.77"D (62.1 cm x 98.2 cm x 12.1 cm)
- 33.7 lbs (15.3 kg) - approximated

### Package Specifications:

- Package Quantity: 1 per case
  - 45"L x 8"W x 32"H (114.3 cm x 20.3 cm x 81.3 cm)
  - 40.0 lbs (18.1 kg) - approximated

### Alternative Products (sold separately):

- RE101-0512: Semi-Recessed PPE Dispensing System (shown below)





## Installation

Always mount dispensers securely *prior* to loading with product.

- Door can be locked or unlocked using a small flat object, such as a coin, screwdriver, etc.

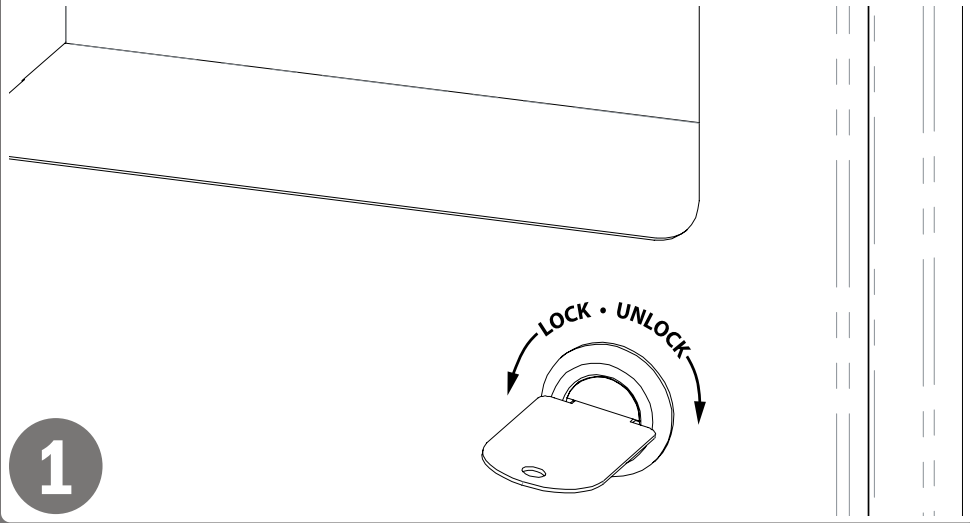

- Door can be removed by squeezing and turning posts on hinges as shown.

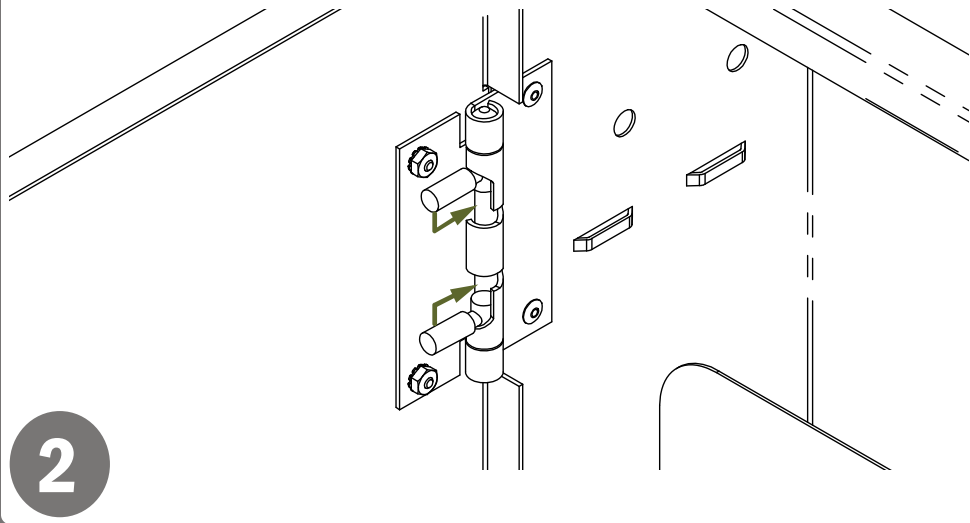

### Parts included:

- Semi-recessed dispenser

### Tools Required:

- No tools required to assemble dispenser

## Care and Construction

### Powder-Coated Steel

### Material Characteristics

#### Designed for Long-Term Use

Our steel dispensers and stands are coated with polyester powders which makes them highly resistant to corrosion.

Powder-coated steel is ideal for dispensers used in a healthcare or an industrial setting because it is impact resistant and is not effected by extremes in temperature.

Dispensers and stands made of powder-coated steel are both attractive and functional, providing years of service.

### Care and Cleaning

For best results, clean by washing the surface with a diluted solution of a mild, non-abrasive detergent in cold or warm water and a non-abrasive cloth. Standard hospital cleaning supplies can be used. Dry with a soft cloth. Do not use any solvent-based materials, abrasives (e.g. Scotch-brite, steel wool), or apply excessive force during cleaning.